

Service Replacement Parts

Advanced Design 10"x1 3/4" Electric Brake

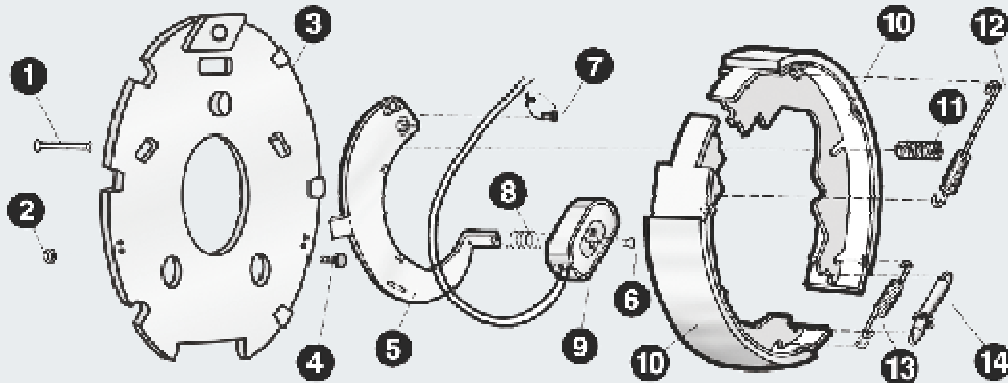

2,200 - 3,500lb.



Parts List

| No. | Brake Part Description | AL-KO Part No. | Hayes Part No. | No. | Brake Part Description | AL-KO Part No. | Hayes Part No. |
|-----|--|----------------|----------------|-----|------------------------------|----------------|----------------|
| 0 | RH Brake Assembly Complete | 1530116 | — | 8 | Magnet Spring | 568103 | — |
| 0 | LH Brake Assembly Complete (Shown) | 1530117 | — | 9 | Magnet Assembly (Green Wire) | 568119 | — |
| 1 | Shoe Hold Down Pin | 5785 | — | 10 | Primary Shoe & Lining | 1530114 | — |
| 2 | Brake Mounting Nut $\frac{7}{16}$ " - 20 | 363312 | — | 11 | Shoe Hold Down Cup & Spring | 568093 | — |
| 3 | Backing Plate Assembly | 5050 | — | 12 | Shoe Retract Spring | 568097 | — |
| 4 | Brake Mounting Stud ($\frac{7}{16}$ " - 20) | 1530112 | — | 13 | Adjuster Screw Spring | 568095 | — |
| 5 | RH Lever Assembly | 568121 | — | 14 | Adjuster Screw Assembly | 568110 | — |
| 5B | LH Lever Assembly (Shown) | 568122 | — | 14B | Adjuster Screw Socket | 568086 | — |
| 6 | Clip, Wire & Magnet | 568092 | — | | Magnet Wire Loom | 5683371 | — |
| 7 | Strain Relief (Magnet Wire) | 568090 | — | | | | |

WARNING: AL-KO Kober Corporation manufacture hubs and drums that are compatible with many wheels used in the trailer industry that have matching bolt patterns. AL-KO does not manufacture wheels, nor do they recommend a specific wheel for compatibility with the hubs and drums they manufacture. The wheel manufacturer should be contacted for proof of compatibility before use.