

# Service Replacement Parts

## 7" x 1 1/4" Electric Brake

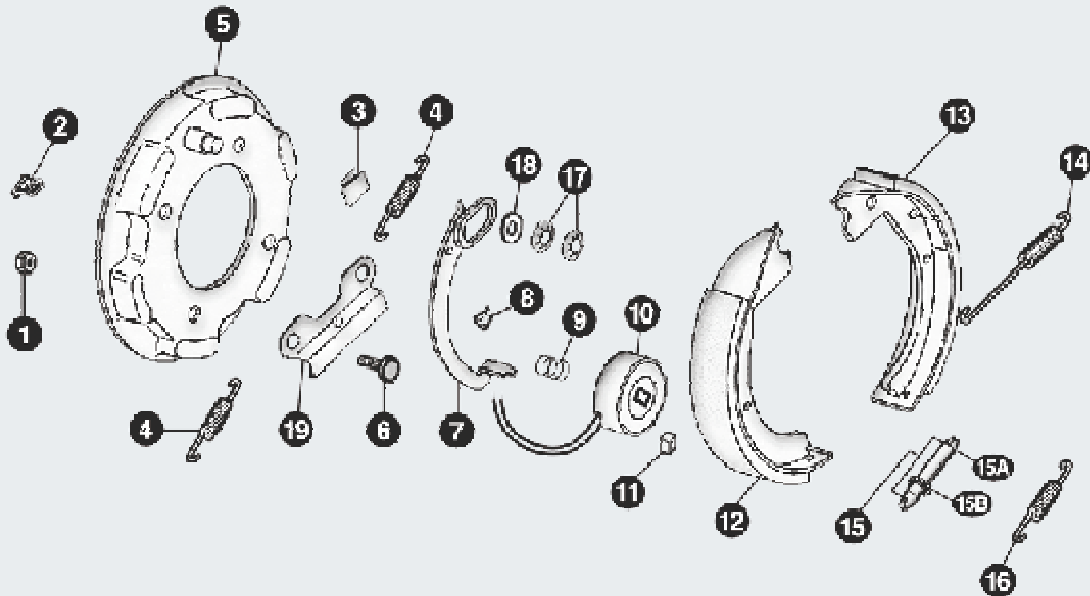

500 - 2,200lb.



### Parts List

No.	Brake Part Description	AL-KO Part No.	Hayes Part No.	No.	Brake Part Description	AL-KO Part No.	Hayes Part No.
0	RH Brake Assembly Complete	623763	09230201	10	Magnet Assembly	623752	—
0	LH Brake Assembly Complete (Shown)	623762	09230202	11	Clip, Magnet	606358	—
1	Brake Mounting Nut 7/16" - 20	363312	090616	12	Primary Shoe & Lining (Shown)	623757	—
2	Plug Adjuster Slot	606367	—	13	Secondary Shoe & Lining	623758	—
3	Shoe Hold Down Clip	606366	—	14	Shoe Retractor Spring	606382	—
4	Shoe Centering Spring	606380	—	15	Adjuster Screw Assembly	606357	—
5	Backing Plate Assembly	N/A	—	15A	Adjuster Screw Socket	606364	—
6	Brake Mounting Stud (7/16" - 20)	606360	—	15B	7" Adjuster Nut	606356	—
7	RH Lever Assembly	623754	—	16	Adjuster Screw Spring	606374	—
7	LH Lever Assembly (Shown)	623753	—	17	Clip, Anchor Pin/Lever	606372	—
8	Clip, Wire	606373	—	18	7" Brake Washer	700140	—
9	Magnet Spring	606381	—	19	Support Plate 7" Electric Brake	606369	—

**WARNING:** AL-KO Kober Corporation manufacture hubs and drums that are compatible with many wheels used in the trailer industry that have matching bolt patterns. AL-KO does not manufacture wheels, nor do they recommend a specific wheel for compatibility with the hubs and drums they manufacture. The wheel manufacturer should be contacted for proof of compatibility before use.