

Service Replacement Parts

10" x 2 1/4" Electric Brake 4.0K/4.4K

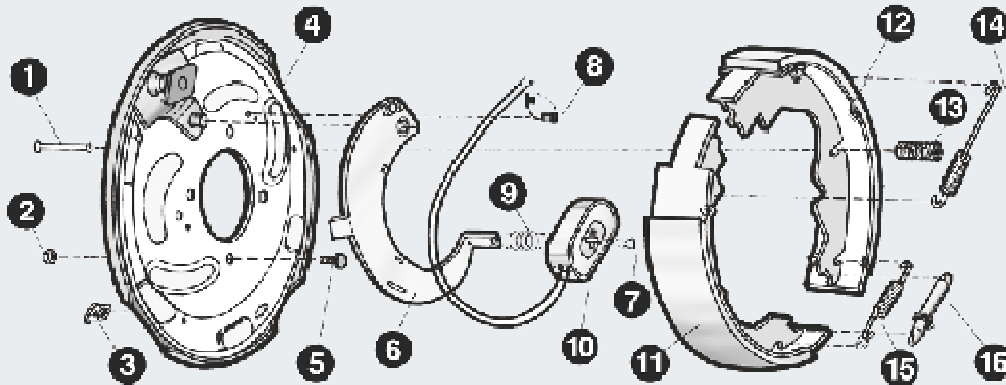

4,000 - 4,400lb.

Parts List

No.	Brake Part Description	AL-KO Part No.	Hayes Part No.	No.	Brake Part Description	AL-KO Part No.	Hayes Part No.
0	RH Brake Assembly Complete	—	568998	9	Magnet Spring	568103	096522
0	LH Brake Assembly Complete (Shown)	—	568999	10	Magnet Assembly (Green Wire)	K568119	—
1	Shoe Hold Down Pin	568094	09661104	11	Primary Shoe & Lining	568995	—
2	Brake Mounting Nut 7/16" - 20	363312	090616	12	Secondary Shoe & Lining	568996	—
3	Plug, Adjuster Slot	568089	096932	13	Shoe Hold Down Cap & Spring	568093	10443
4	Backing Plate Assembly	—	—	14	Shoe Retract Spring	568097	09650603
5	Brake Mounting Stud (7/16" - 20)	6722	090762	15	Adjuster Screw Spring	568095	096526
6	RH Lever Assembly	568121	60283001	16	Adjuster Screw Assembly	568110	60272401
6	LH Lever Assembly (Shown)	568122	60282901	16	Adjuster Screw Socket	568086	60272801
7	Clip, Wire & Magnet	568092	09680815		Magnet Wire Loom	5683371	—
8	Strain Relief (Magnet Wire)	568090	—				

WARNING: AL-KO Kober Corporation manufacture hubs and drums that are compatible with many wheels used in the trailer industry that have matching bolt patterns. AL-KO does not manufacture wheels, nor do they recommend a specific wheel for compatibility with the hubs and drums they manufacture. The wheel manufacturer should be contacted for proof of compatibility before use.