

# Service Replacement Parts

## 12" x 2" Hub/Drum

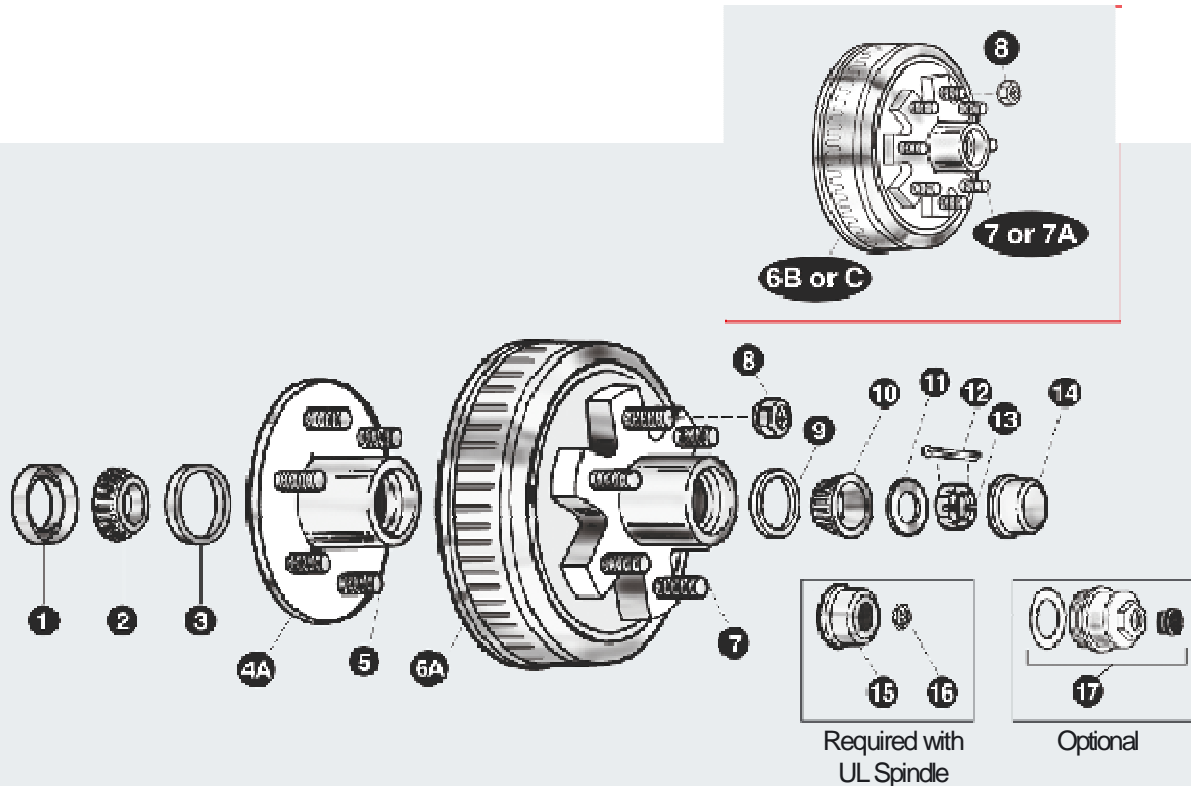

### Parts List

No.	Brake Part Description	AL-KO Part No.	Hayes Part No.	No.	Brake Part Description	AL-KO Part No.	Hayes Part No.
1	Grease Seal Double Lip 2 1/4" (Prior to 1997)	363497	09103304	8	Wheel Nut, 1/2" - 20 60° Cone	363203	090608
1	Grease Seal Double Lip 2 1/8" Shaft	568862	09103304L	8	Wheel Nut, 9/16" - 18 60° Cone	363895	090640
2	Inner Bearing Cone 25580	363196	093703	8	Wheel Nut, 5/8" - 90° Cone	363698	090643
3	Inner Bearing Cup 25520	363911	093701	9	Outer Bearing Cup (15245) for 6 on 5.5" BC	363916	093725
4	Idler Hubs w/ Cups & Studs	—	—	9	Outer Bearing Cup (14276) for 8 on 6.5" BC	363915	093719
4A	6 on 5.5" Bolt Circle	363200	09080134	10A	Outer Bearing Cone (15123) for 6 on 5.5" BC	363420	093709
4B	8 on 6.5" Bolt Circle	363902	09080448	10	Outer Bearing Cone (14125A) for 8 on 6.5" BC	363397	093720
5	Stud 1/2" - 20 x 1.81 Long Knurl	1530092	09251525	11	Spindle Washer 1" x 2" OD	568326	09050901
6	Hub & Drum w/ Cups & Studs	—	—	12	Cotter Pin	363528	091901
6A	6 on 5.5" Bolt Circle (for 15123)	363239	09084604	13	Spindle Nut 1" - 14	363257	09060101
6B	8 on 6.5" Bolt Circle (for 14125A) 1/2"	363236	09089264	14	Grease Cap for 15123 Bearing	363199	092101
6B	865 (14125A) 1/2" Oil	363589	—	14	Grease Cap for 14125A Bearing	363419	092110
6C	8 on 6.5" Bolt Circle (14125A) 9/16"	568182	09089324	15	Grease Cap for 15123 Bearing (UL)	363496	09210102
6C	865 (14125A) 9/16" Oil	568929	—	15	Grease Cap for 14125A Bearing (UL)	363775	09210103
6D	865 (14125A) 5/8" Oil	568698	—	16	Rubber Plug (UL)	568067	09213611
6D	865 (14125A) 5/8" Oil	1530003	—	17	K568347 Oil Cap Kit 7K/RT/ST/DR80	—	—
7	Stud 1/2" - 20 x 2.50 Long Knurl	363909	09251512				
7A	Stud 9/16" - 18 x 2.75 Long Knurl	363906	09251100				

**WARNING:** AL-KO Kober Corporation manufacture hubs and drums that are compatible with many wheels used in the trailer industry that have matching bolt patterns. AL-KO does not manufacture wheels, nor do they recommend a specific wheel for compatibility with the hubs and drums they manufacture. The wheel manufacturer should be contacted for proof of compatibility before use.

5,200 - 7,000lb.